

DN8 WEIR SIZE ONLY

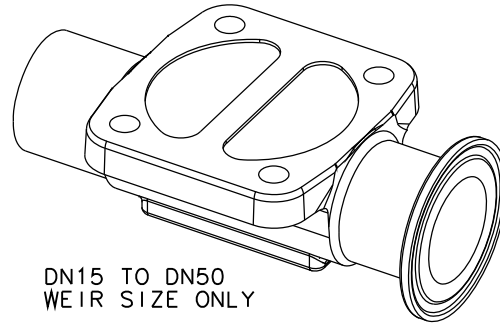

DN15 TO DN50
WEIR SIZE ONLY

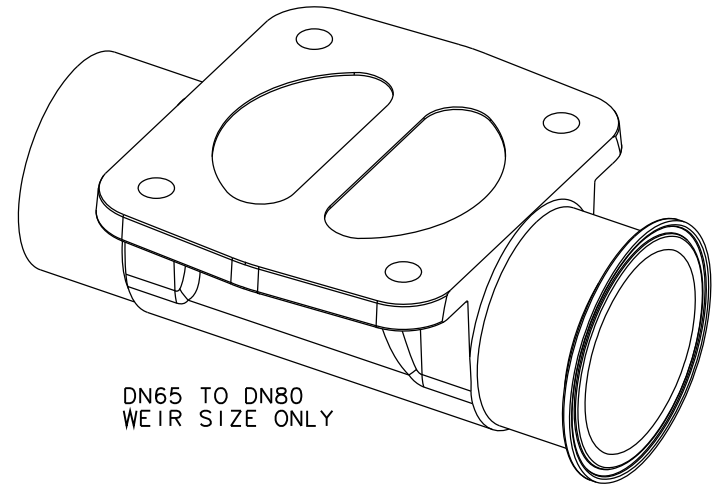

DN65 TO DN80
WEIR SIZE ONLY

VALVE SIZE mm	A mm	B mm	C mm	ØD mm	ØE mm	ØF mm	G DEGREES	BODY WEIGHT KGS
DN8	78.0	21.5	9.6	13.5	10.3	34.0	20	0.1
DN15 (DN10 END)	108.0	30.5	13.0	17.2	14.0	34.0	25	0.3
DN15	108.0	30.5	13.0	21.3	18.1	34.0	19	0.3
DN20	117.0	28.5	16.0	26.9	23.7	50.4	21	0.4
DN25	127.0	28.5	19.5	33.7	29.7	50.4	12	0.7
DN40 (DN32 END)	159.0	31.5	28.0	42.4	38.4	63.9	22	1.5
DN40	159.0	31.5	28.0	48.3	44.3	63.9	17	1.3
DN50	190.0	40.9	33.5	60.3	55.1	77.4	16	2.0
DN65	217.0	42.0	40.5	76.1	70.9	90.9	14	3.3
DN80	254.0	48.0	48.0	88.9	83.7	105.9	20	5.2

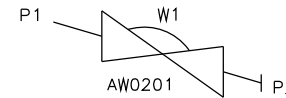
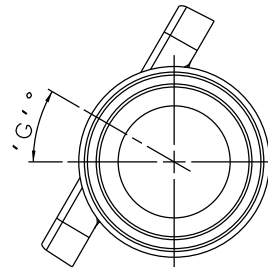

SELF DRAIN
POSITION IN
HORIZONTAL
ORIENTATION

DRAIN ANGLE TOLERANCE = +/-2°

The information on this sheet is Private and Confidential and is the property of Crane Process Flow Technologies Limited and must not be published directly or indirectly in any manner whatsoever without the written permission of the Company and must not be used in any way detrimental to their interests.
© Crane Process Flow Technologies

CRANE Process Flow Technologies
A Crane Co. Company

Saunders
The Science Inside

Title
SCHEDULE OF LEADING DIMENSIONS FOR 2-WAY
MKIV FORGED BODY WITH ISO 1127 S1 BUTT WELD END
AND HYGIENIC CLAMP END WITH ISO 1127 S1 BORE.

Drawn RI	Date 08.11.11	UNCONTROLLED IN HARD COPY FORMAT	
Checked RND	Date 03.10.12		
First Angle Projection Method E	DO NOT SCALE	Drawing No. WEB-093	Issue. 2

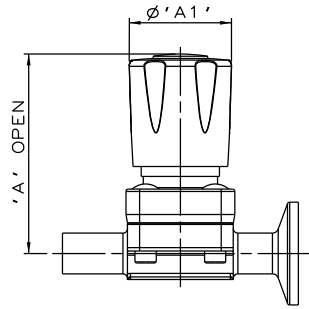

PURE PERFORMANCE BONNET ASSEMBLY

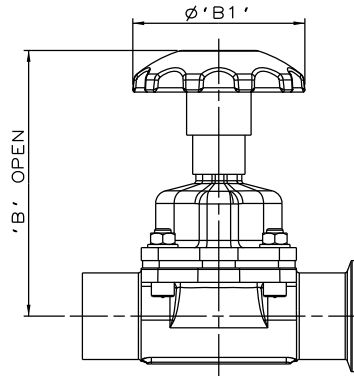

SS NON SEALED BONNET ASSEMBLY

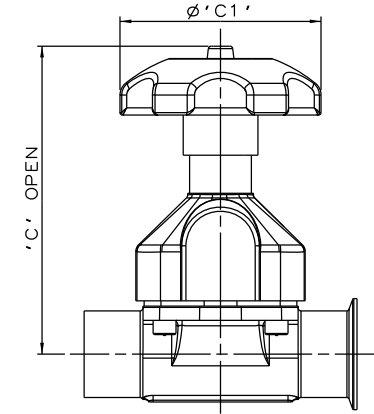

PES BONNET ASSEMBLY

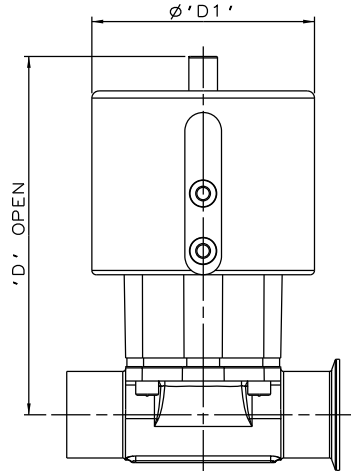

EC ACTUATOR (ALL MODES)

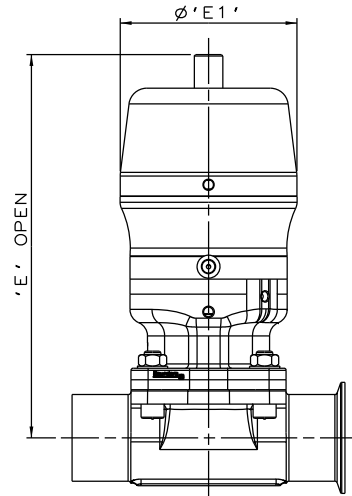

*S360 ACTUATOR

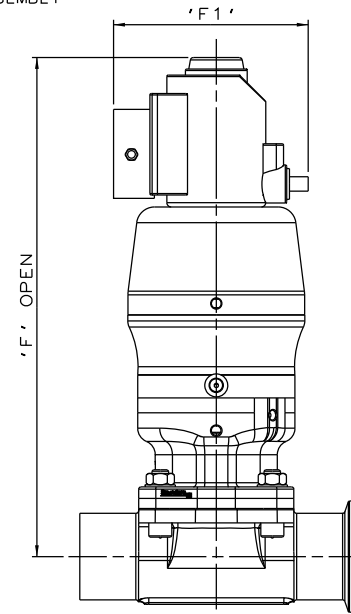

*S360 ACTUATOR WITH I-VUE SENSOR

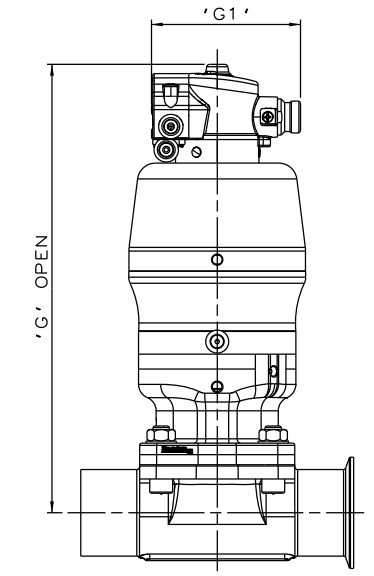

*S360 ACTUATOR WITH M-VUE SENSOR

* DIMENSIONS SHOW MAXIMUM ENVELOPE FOR ALL MODES

VALVE SIZE	A		A1		B		B1		C		C1		D		D1		E		E1		F		F1		G		G1		
	mm	inch	mm	inch	mm	inch	mm	inch	mm	inch	mm	inch	mm	inch	mm	inch	mm	inch	mm	inch	mm	inch	mm	inch	mm	inch	mm	inch	
DN8	0.25	66.0	2.60	34.0	1.34	N/A	N/A	N/A	N/A	N/A	N/A	N/A	N/A	88.6	3.49	58.0	2.28	89.6	3.53	55.0	2.18	188.6	7.43	136.0	5.35	154.6	6.09	103.8	4.09
DN15	0.50	N/A	N/A	N/A	N/A	88.0	3.46	62.0	2.44	111.0	4.37	62.0	2.44	115.0	4.53	70.0	2.75	139.0	5.47	67.5	2.66	235.0	9.25	136.0	5.35	199.3	7.85	103.8	4.09
DN20	0.75	N/A	N/A	N/A	N/A	91.0	3.58	62.0	2.44	117.0	4.61	62.0	2.44	160.0	6.30	103.0	4.05	167.0	6.57	98.0	3.87	263.0	10.35	136.0	5.35	228.0	8.98	103.8	4.09
DN25	1.00	N/A	N/A	N/A	N/A	113.5	4.47	80.0	3.15	147.5	5.81	80.0	3.15	167.5	6.59	103.0	4.05	175.5	6.91	98.0	3.87	272.5	10.73	136.0	5.35	236.5	9.31	103.8	4.09
DN40	1.50	N/A	N/A	N/A	N/A	164.0	6.46	120.0	4.72	205.0	8.07	140.0	5.51	231.0	9.09	155.0	6.10	230.0	9.06	123.0	4.84	317.0	12.48	136.0	5.35	281.0	11.06	103.8	4.09
DN50	2.00	N/A	N/A	N/A	N/A	185.5	7.30	120.0	4.72	214.5	8.44	140.0	5.51	249.5	9.82	155.0	6.10	272.5	10.73	150.0	5.92	356.5	14.04	136.0	5.35	320.5	12.62	103.8	4.09
DN65	2.50	N/A	N/A	N/A	N/A	233.5	9.19	170.0	6.69	226.5	8.92	140.0	5.51	N/A	N/A	N/A	N/A	334.5	13.17	186.0	7.32	414.5	16.32	136.0	5.35	N/A	N/A	N/A	N/A
DN80	3.00	N/A	N/A	N/A	N/A	259.0	10.20	230.0	9.06	299.0	11.77	250.0	9.84	N/A	N/A	N/A	N/A	407.0	16.02	236.0	9.29	480.0	18.90	136.0	5.35	N/A	N/A	N/A	N/A

The information on this sheet is Private and Confidential and is the property of Crane Process Flow Technologies Limited and must not be published directly or indirectly in any manner whatsoever without the written permission of the Company and must not be used in any way detrimental to their interests.
© Crane Process Flow Technologies

CRANE Process Flow Technologies
A Crane Co. Company

Saunders
The Science Inside

Title
SCHEDULE OF LEADING DIMENSIONS FOR 2-WAY MKIV FORGED BODY WITH BUTT WELD ISO 1127 S1 TUBE END AND HYGENIC CLAMP END WITH ISO 1127 S1 BORE.
FITTED WITH TOPWORKS OPTIONS

Drawn R1	Date 08.05.17	UNCONTROLLED IN HARD COPY FORMAT
Checked RND	Date 08.05.17	
First Angle Projection	DO NOT SCALE	Drawing No. WEB-093-ASSY
Method E		Issue. 1